

NOTE
 * FOR INFORMATION PURPOSES ONLY
 NOT TO BE OBT.

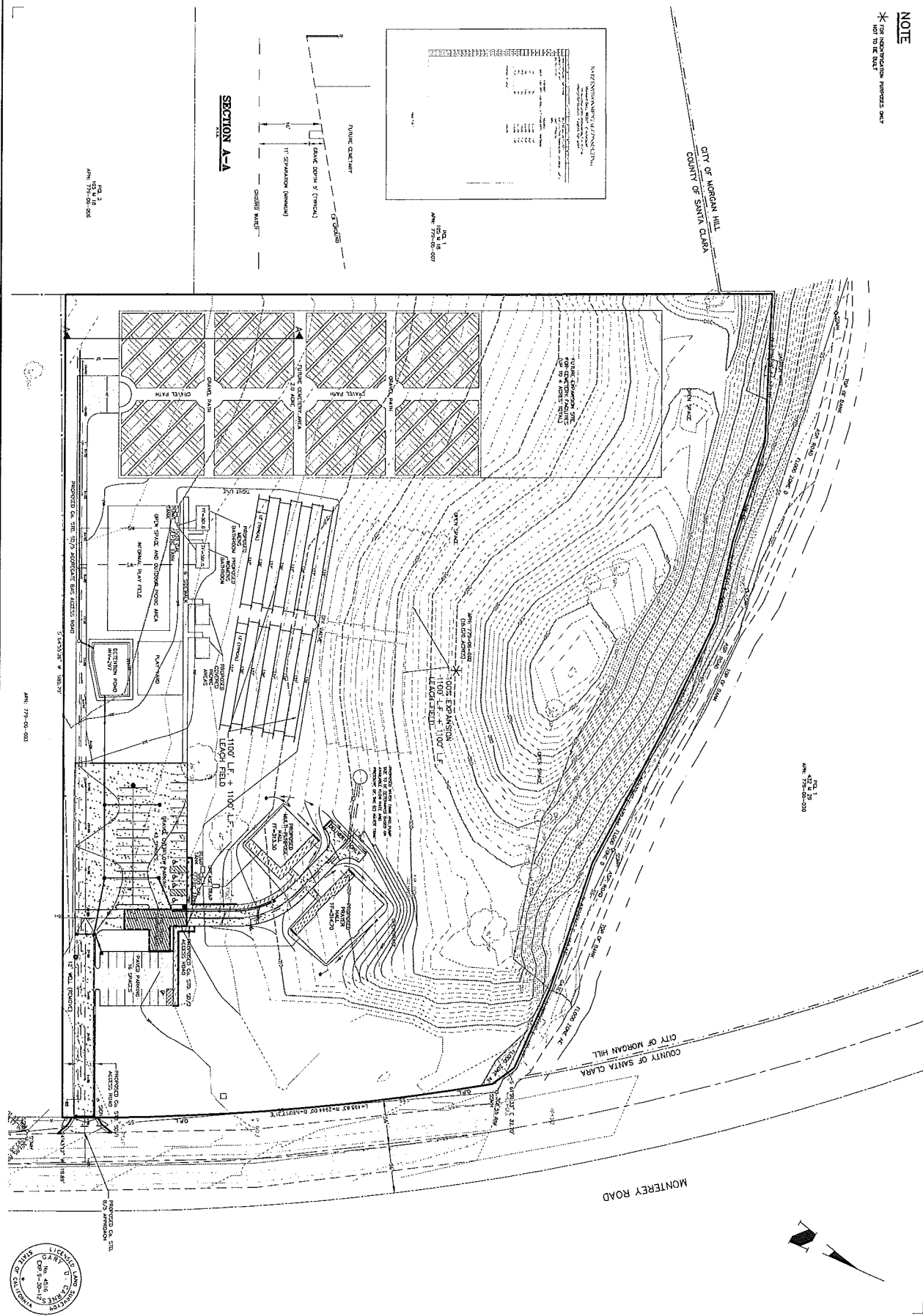

SHEET
 1
 OF
 1
 Job No. 0642
 DWN BY: G.C.
 PROJ. MANAGER: G.C.

DATE: 05-10
SCALE: 1"=50'
SITE AND SEPTIC PLAN
THE CORDOBA CENTER
PORTION OF LOT 42, "P" M 42-50
COUNTY OF SANTA CLARA, CA.

No.	DATE	REVISION
1	06-08-12	ADD POSE EXPANSION TO LEADFIELD & NOTE

CARNES & ASSOCIATES
 9505 SUGAR BABE DRIVE
 GILROY, CALIFORNIA 95020
 408-847-2013

Attachment: Attachment B - Appeal of Silicon Valley Islamic Center (64492 : Appeals of the Planning Commission decision granting approval of